



BLOCK 3 PARK

Community Meeting #4 (4/29/21) Survey Results



Building Design & Construction

SURVEY RESULTS POST COMMUNITY MEETING #4

WHO? 58 total respondents

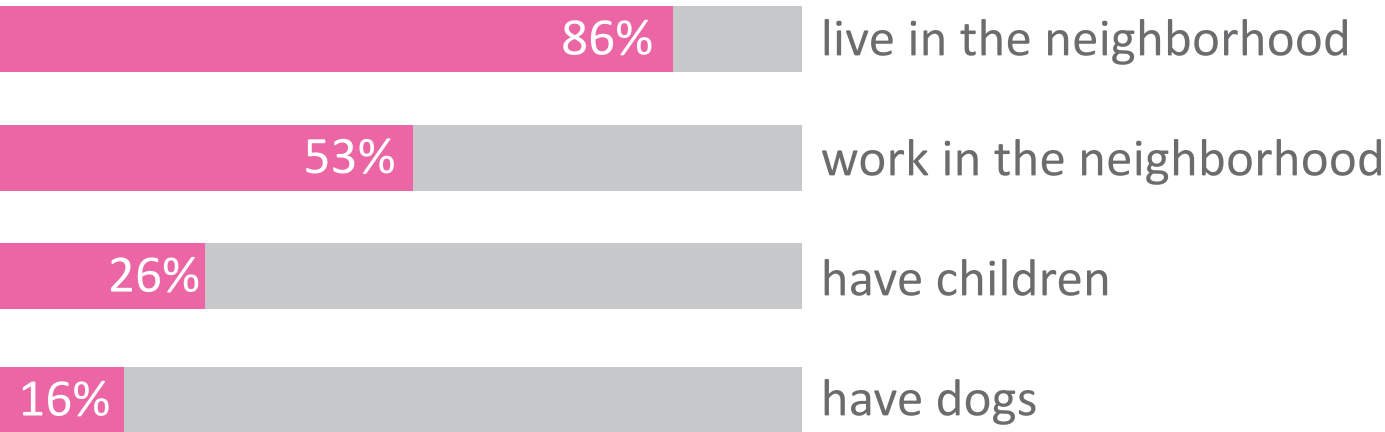

Age of Respondents:

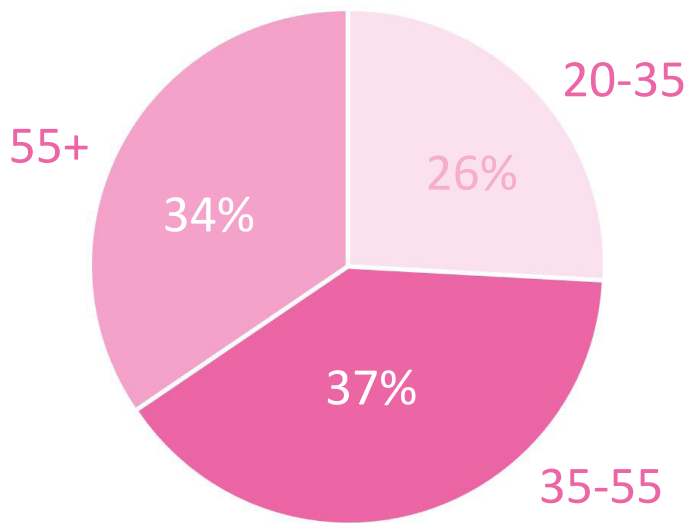

If you are a parent or caretaker, which age bracket is your child/children?:

12 total respondents

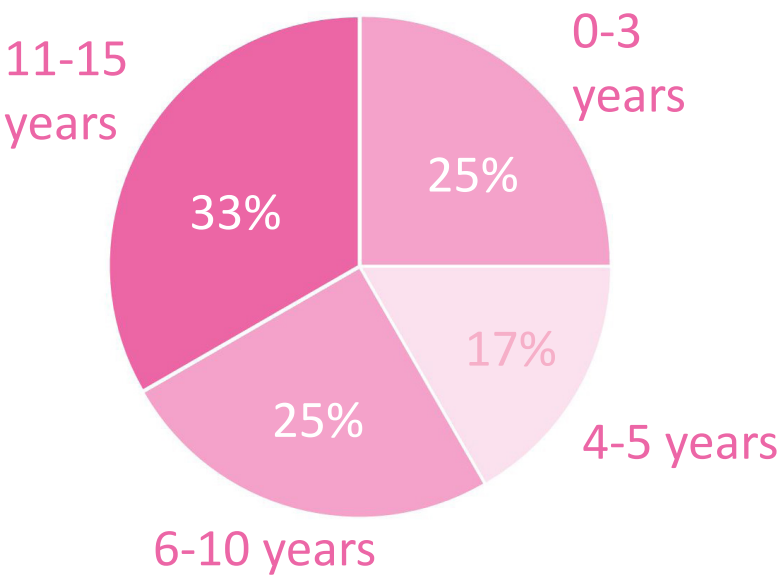

DID YOU ATTEND OUR COMMUNITY MEETINGS?

Asked in Community Meeting #4 survey

Community Meeting #1 (March 4, 2020, in-person, 50 attendees)



Community Meeting #2 (September 9, 2020, 77 attendees)



Community Meeting #3 (November 18, 2020, 67 attendees)



Community Meeting #4 (April 29, 2021, 51 attendees)

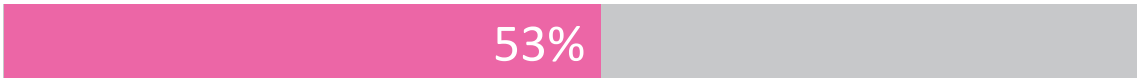

I have not attended any community meetings for this project:



STEWARDSHIP BUILDING

For the Stewardship/Maintenance Building concepts, which option are you most drawn to?

Option 1: Envelop



- Prismatic form
- Offset location within grove
- Responds to new architectural forms nearby
- Perforated metal skin
- Can glow internally at night



Option 2: Bow



- Organic form frames views to each corner
- Central location within grove
- Replicates curves from site design
- Earthy materials and color palette
- Integrated with landscape

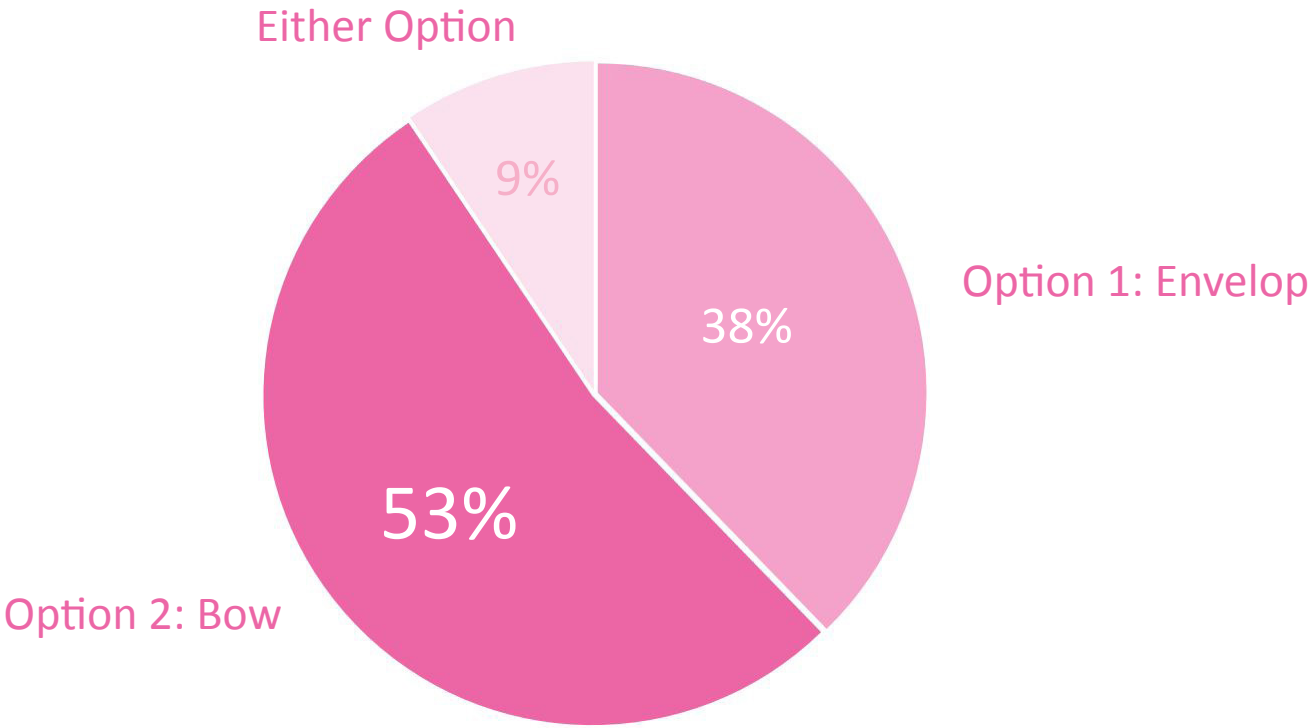
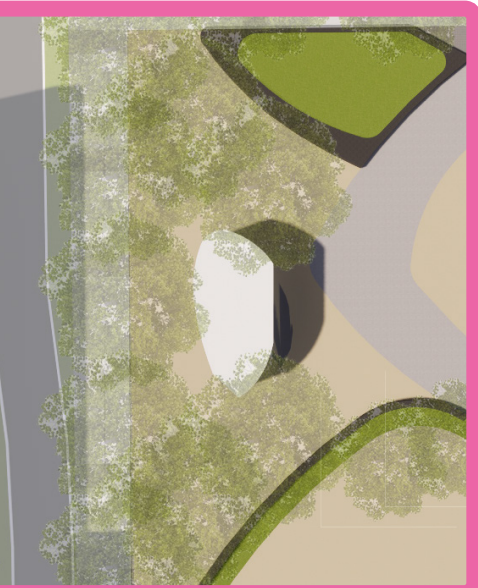

Public Comments:

“More harmonious with the site. “Bow” looks like it belongs there!”

“Very strong preference for the more organic form of Option 2.”

“I like the curves for the Bow option but the glowing internally at night tipped the scale to the Envelop option.”

PLAYGROUND

For the Playground concepts, which option are you most drawn to?

Option 1: Integrated Play

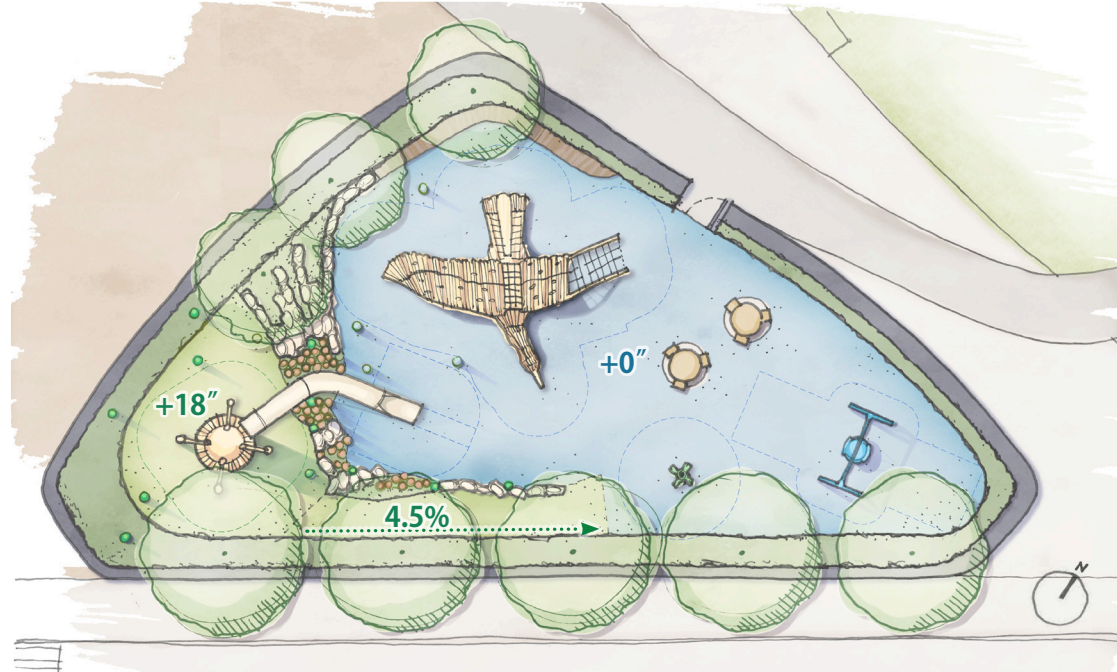

Supports mixed-age play on park level and provides school age play at elevated corner

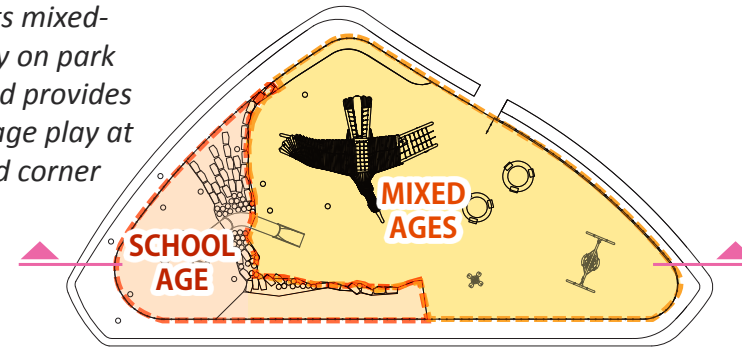

Elevated (18")
Park Level
Diagrammatic Section

● Park Level
● Elevated (18")

Option 2: Zoned Play

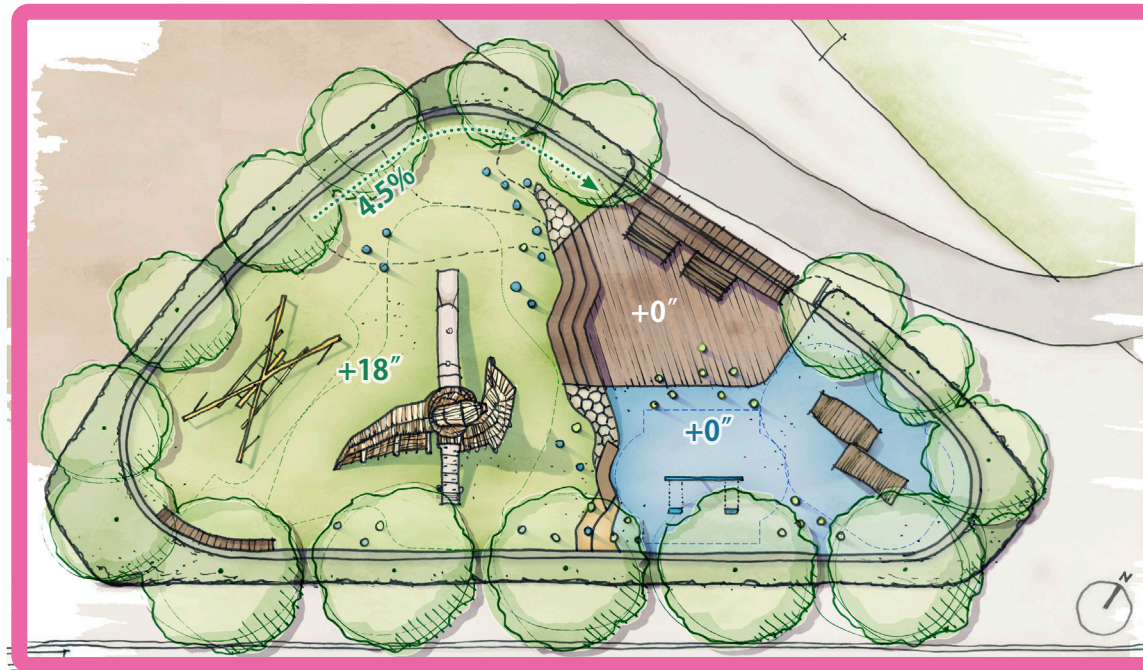

Separates toddler play from school age play by a stepped 18" elevation change

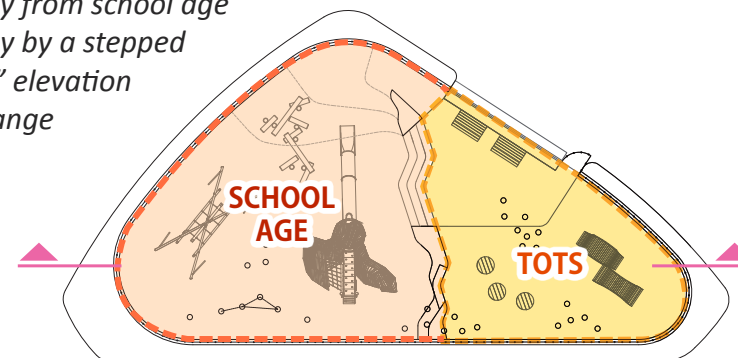

Elevated (18")
Park Level
Diagrammatic Section

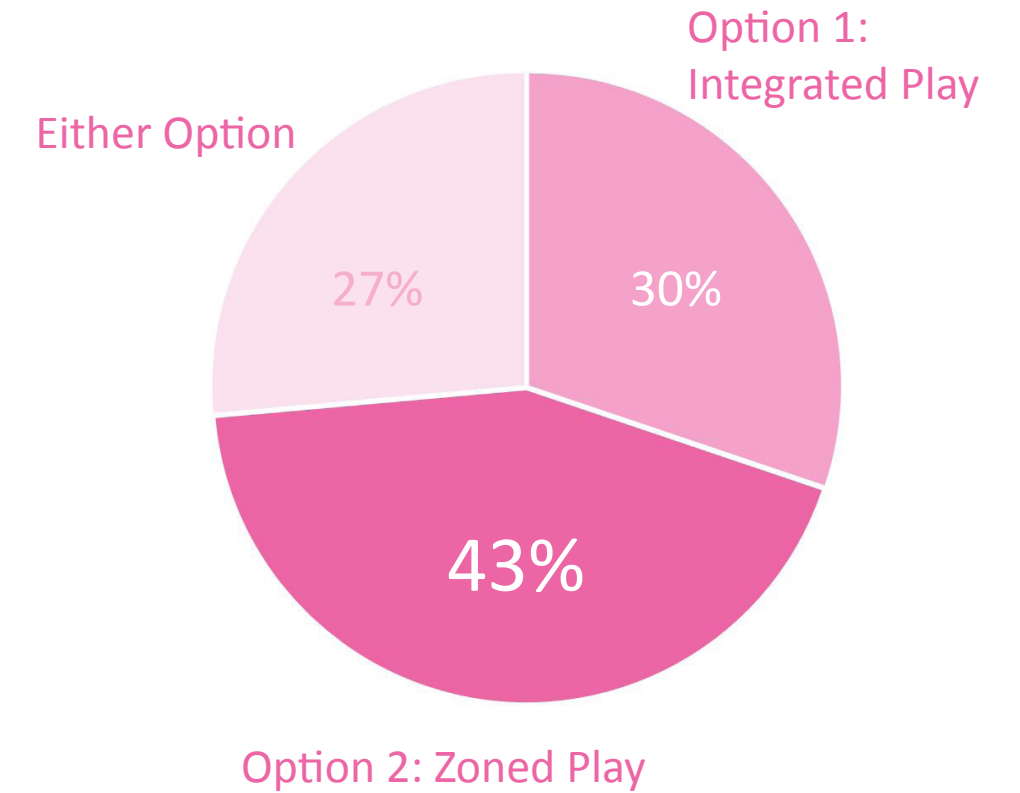

Public Comments:

"Lots of toddlers in this area. Feels nice to have a separate section for their needs."

"I think toddlers need their own play space. Older children can be too rough and tumble around tots."



PLAYGROUND - MAIN PLAY STRUCTURE

Which children’s main play structure are you most drawn to?

Option 1: Integrated Play

SCULPTURAL WATERFOWL PLAY STRUCTURE



OR

TIMBER PLAY STRUCTURE - ALTERNATE



Either Option

Timber Play Structure

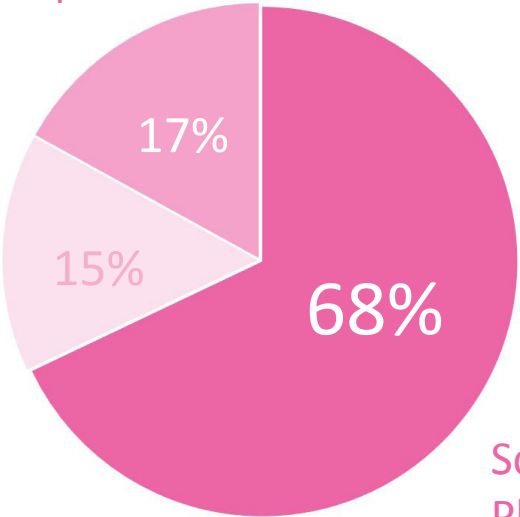

Sculptural Waterfowl Play Structure

Option 2: Zoned Play

SCULPTURAL WATERFOWL PLAY STRUCTURE

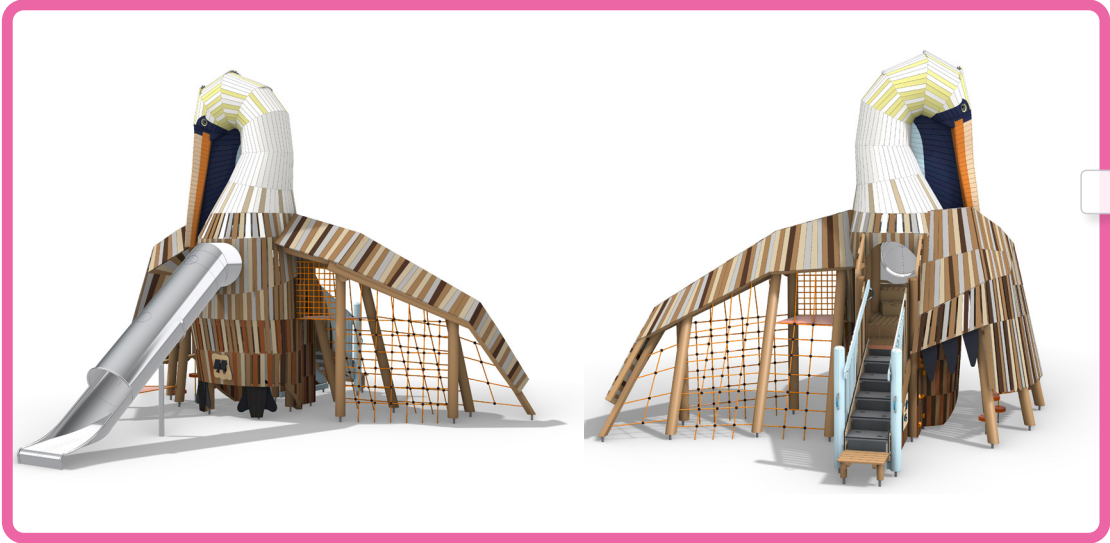

OR

TOWER PLAY STRUCTURE - ALTERNATE

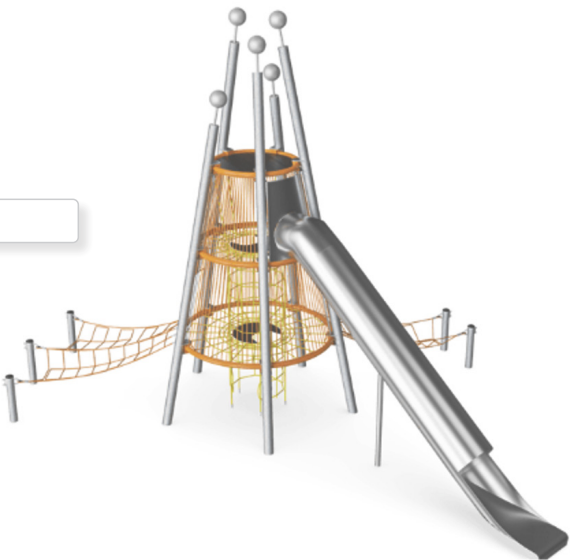

Either Option

Tower Play Structure

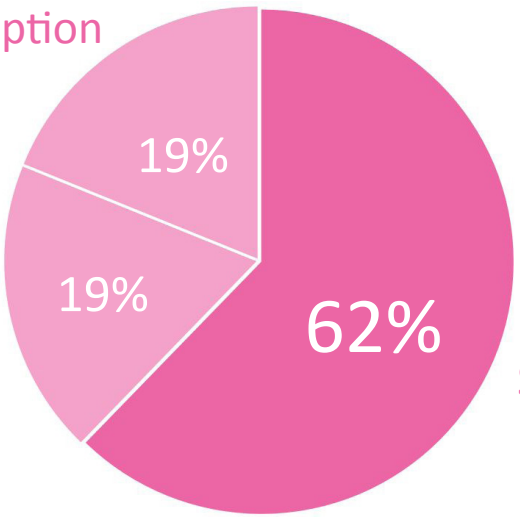

Sculptural Waterfowl Play Structure



PLAYGROUND - SWINGS

Do you have a preference on the multi-user swing?

Multi-user Swing



Saucer Swing



Rope Swing



3-Tier Swing

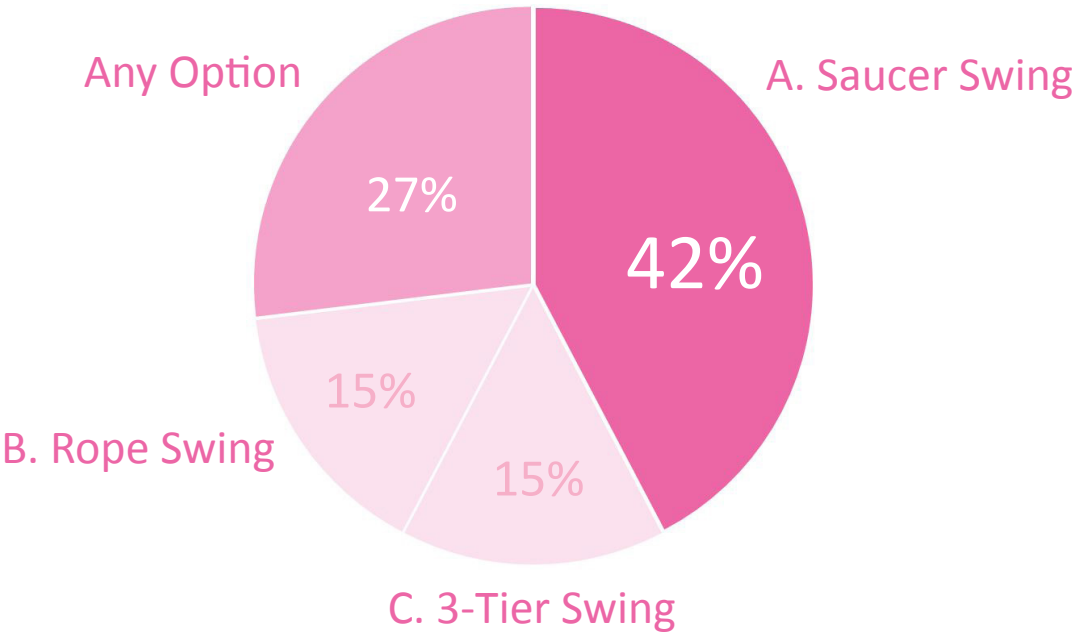

Is it important to have a toddler swing in the playground?

Toddler Swing

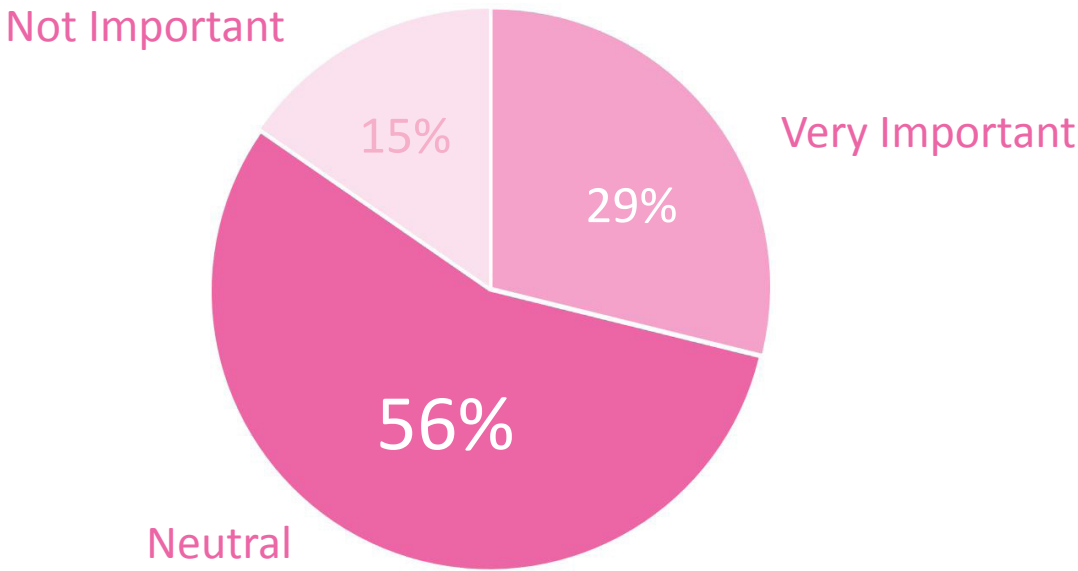

PARK DESIGN

Which area of the park would you likely spend the most time in?

